

# HW 163

200 Watt max

8  $\Omega$

Ø 165 mm / 6,5"

4  $\Omega$   CAR CW 162

## WOOFER

Membrana in cellulosa smorzata e sospensione in gomma

Doped paper cone, rubber surround

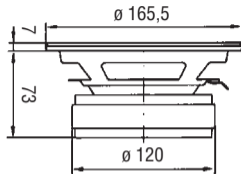

Potenza nominale **90 W**

Impedenza nominale **8  $\Omega$**

Sensibilità (1W/1m) **91 dB**

Ø bobina mobile **38 mm**

Altezza traferro **6 mm**

Fori di fissaggio **4  $\varnothing^5$  /  $\varnothing$  156**

Foro pannello **142 mm**

Re **6,2  $\Omega$**

Fs **41 Hz**

Qms **1,82**

Qes **0,29**

Qts **0,25**

Mms **14,5 g**

Cms **1,04 mm/N**

D **130 mm**

Vas **25 dm<sup>3</sup>**

BxI **8,87 Wb/m**

Xmax **4,5 mm**

$\eta^\circ$  **0,56 %**

Le **0,85 mH**

Peso **2,40 Kg**

